



# Lowood Botanic Core

STREETSCAPE CONCEPT DESIGN

2025



# Design Vision

*A vibrant and inclusive park where community, creativity, and nature come together—inviting exploration, inspiring connection, and nurturing a deep sense of belonging for all.*

Clock park is envisioned as a vibrant, inclusive, and ever-evolving landscape where community, nature, and creativity converge. Informal seating and rest areas along the Rail Trail offer welcoming pauses for cyclists, walkers, and horse riders—spaces to connect, reflect, and enjoy the surrounding beauty. Meandering trails of discovery mirror natural human movement, inviting exploration and deepening the park's sense of wonder and accessibility.

Unprogrammed open spaces spark imaginative play and personal storytelling, nurturing creativity and deeper engagement for all ages. Informal interpretive signage, rich with local history, fosters curiosity, pride, and a meaningful connection to place. Visual cues, organic forms, and locally inspired design elements celebrate

identity and invite playful interaction with art and environment.

Expansive lawns encourage freedom and play, while shaded edges provide comfort, rest, and a sense of refuge—balancing activity with relaxation. A shaded square at the park's edge forms a natural bridge to the town centre, offering a flexible gathering space for community events, markets, and ANZAC Day ceremonies. Terraced slopes transform steeper areas into safe, visually engaging levels for seating, events, and social connection.

This park is a canvas for community life—adaptable, welcoming, and steeped in place—designed to support spontaneous joy, shared experiences, and a lasting sense of belonging.

## Design Principles

### SAFE & INCLUSIVE

The design is shaped by principles of legibility, accessibility, and equity—ensuring clearly defined precincts, DDA compliance, equitable access, CPTED safety standards, and intuitive movement and wayfinding for all users, including pedestrians, cyclists, motorists, and horse riders.



### SHADE & COMFORT

The design prioritises shade and comfort through strategic canopy cover (aligned with CanopyCast benchmarks), well-placed rest nodes, clear visibility, thoughtful material choices, and a commitment to environmental stewardship, creating inviting, and sustainable spaces for all users.



### PLACE IDENTITY

The design celebrates Lowood's unique identity through interpretive signage, storytelling, botanical engagement, cultural and historical references inviting discovery, fostering local pride, and deepening the community's connection to place.



### VIBRANT & ACTIVATED

The design fosters a vibrant and activated park experience through flexible, programmable spaces including an amphitheatre, dynamic play areas, and a central event space ensuring safe, welcoming use throughout the day and into the evening.



## OUR PARK

*Our new park is a welcoming space where everyone can feel at home, with winding trails for walking, cycling, or riding. There are plenty of spots to relax and enjoy the scenery, open lawns for play, and shaded corners for peaceful rest. Through art and signage inspired by our history, the park brings people together to celebrate, reflect, or simply enjoy a quiet moment—it truly feels made for us, by us.*



# Streetscapes

## TOWN CENTRE STREETSCAPES

Upgrading the streetscapes of Lowood’s Town Centre focuses on revitalising its primary streets through a revised pavement strategy that enhances pedestrian comfort and accessibility. Median buildouts will introduce tree planting and greenery, contributing to traffic calming and a more inviting public realm. On-street parking will be reprogrammed to accommodate the tree buildouts, formalised pedestrian crossings, PWD parking, loading zones, and dedicated bus parking, ensuring functionality and inclusivity. For the outer secondary streetscapes, the approach will retain and enhance existing footpaths while implementing a cohesive street tree planting strategy to strengthen the town’s green infrastructure and visual identity.

## Primary Streetscapes

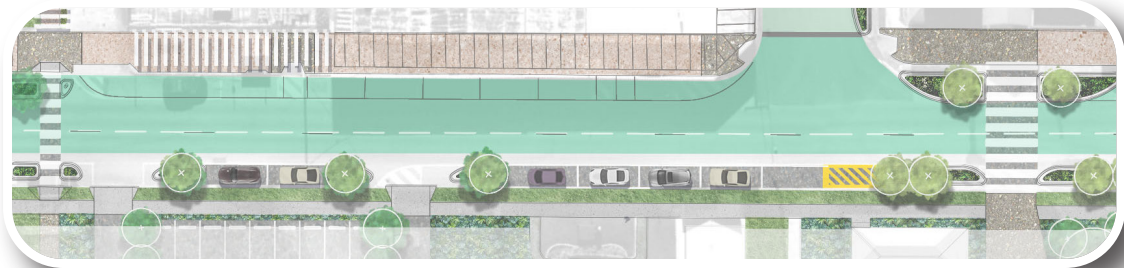

## Secondary Streetscapes

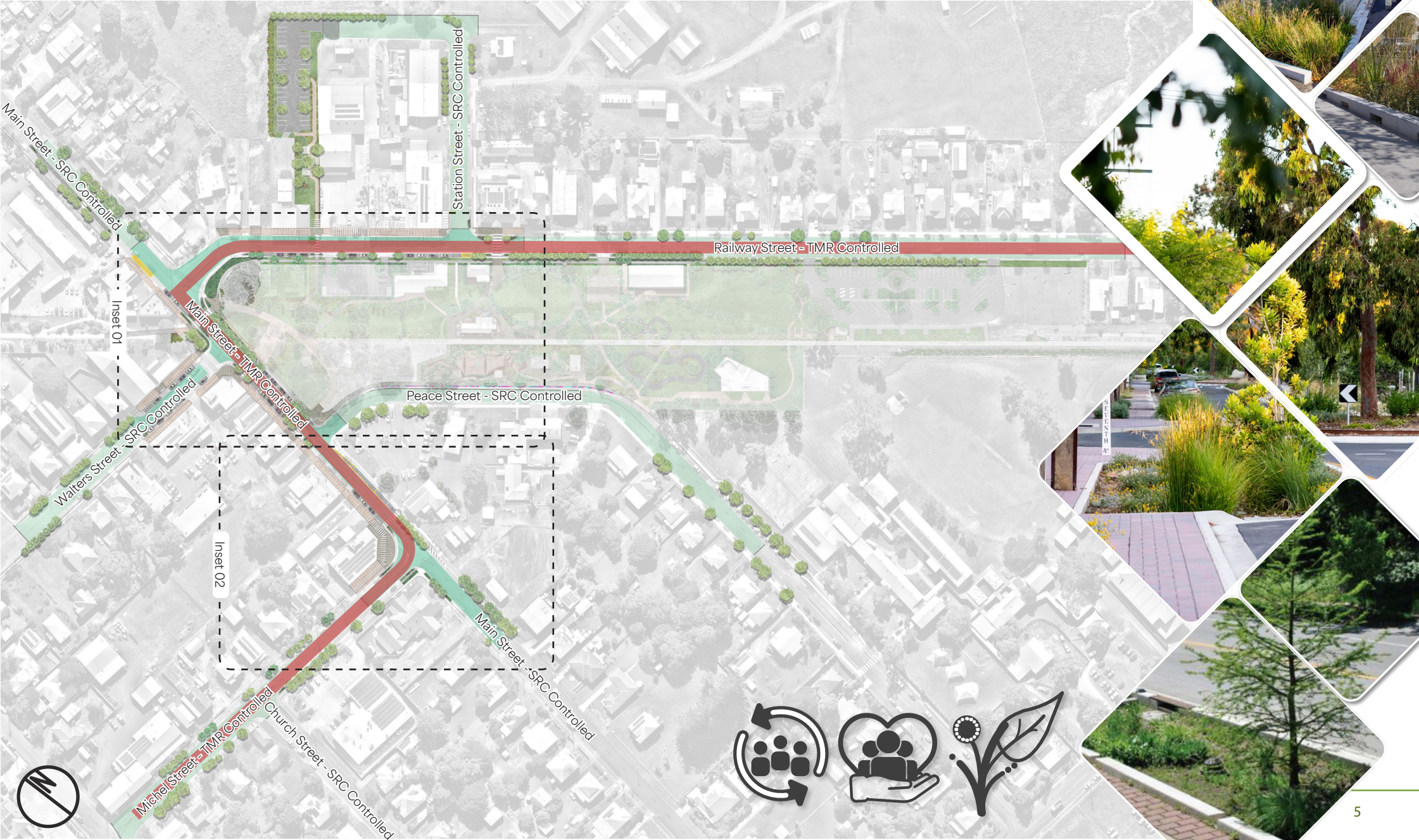
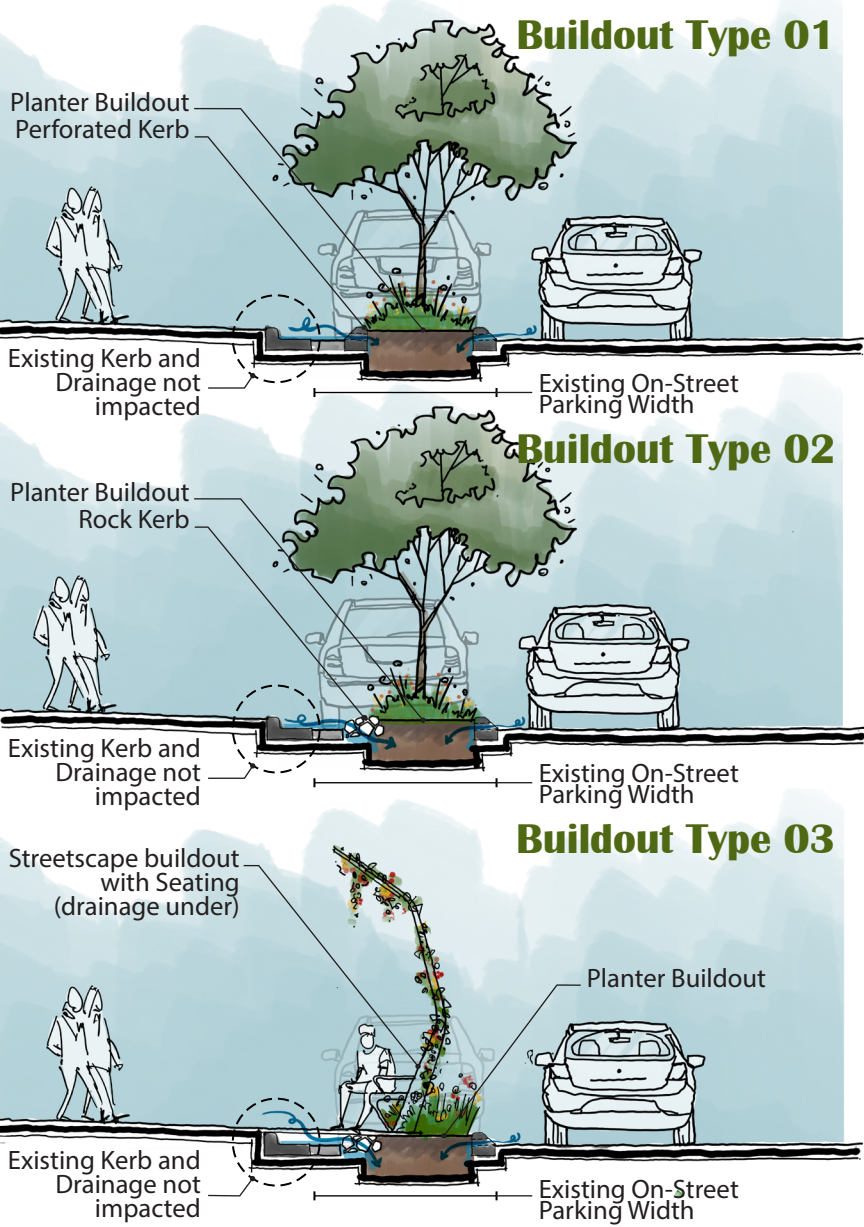
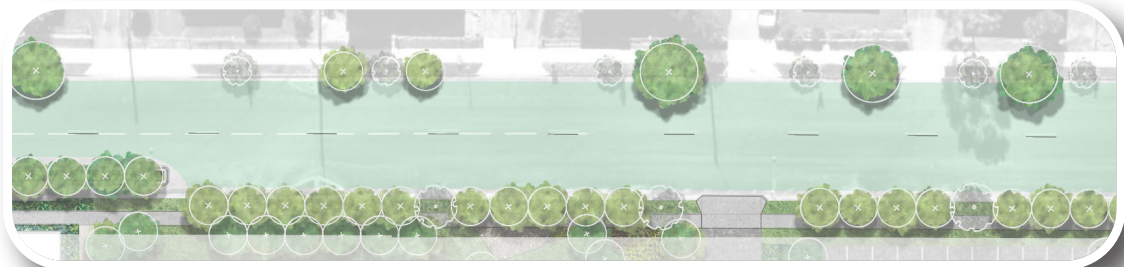



# Streetscapes

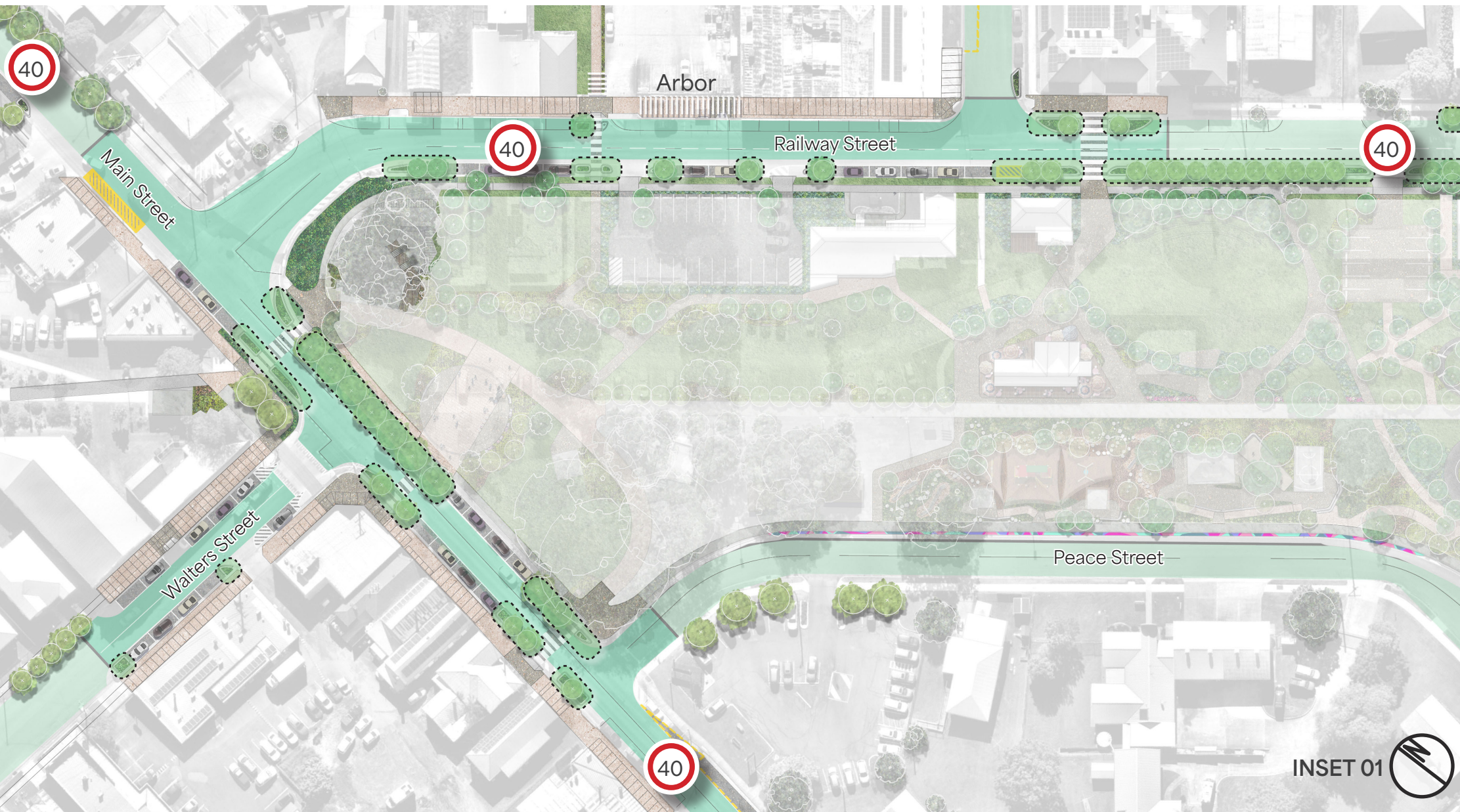

## Primary Streetscapes

Pedestrian crossings over TMR-owned roads within Lowood's Town Centre have been carefully considered during the Concept Design phase, with initial sightline checks and swept path analyses for both small and large vehicles undertaken to inform the placement of median buildouts with trees and associated traffic calming measures. These buildouts not only enhance the streetscape but also serve as pedestrian refuges, improving safety and accessibility. While these preliminary assessments have guided the concept layout, they will require further review and refinement during the Detailed Design phase, in parallel with ongoing engagement between Somerset Regional Council and TMR. This collaborative process will ensure that all crossing points meet safety standards, accommodate vehicle movements, and align with broader transport and streetscape objectives.

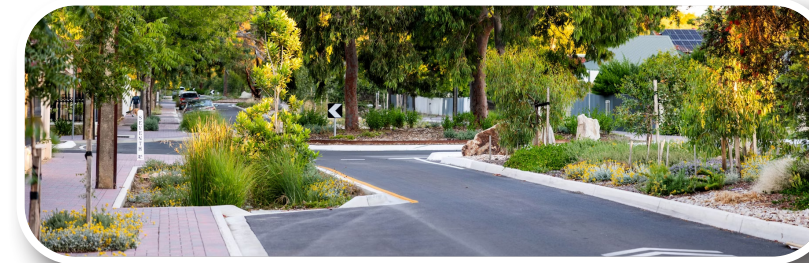



# Trees & Parking



## STREET TREES



*Cupaniopsis anacardioides*  
(Tuckeroo)



*Elaeocarpus eumundi*  
(Eumundi quandong)



*Flindersia australis*  
(Crow Ash)

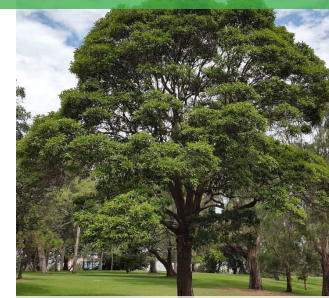

*Lophostemon confertus*  
(Brush Box)



*Tristaniopsis laurina* 'Luscious'  
(Water Gum)



*Waterhousia floribunda*  
'Green Avenue'  
(Weeping Lilly Pilly)

## TREES UNDER POWERLINES



*Buckinghamia celeissima*  
(Ivory Curl)



*Xanthostemon chrysthanus*  
(Golden Penda)



*Callistemon citrinus* 'Kings  
Park Special' - bottlebrush  
(Kings Park Special)

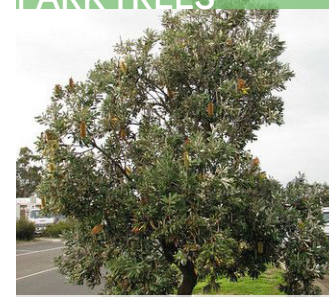

*Banksia integrifolia*  
(Coast Banksia)



*Banksia serrata*  
(Saw Banksia)

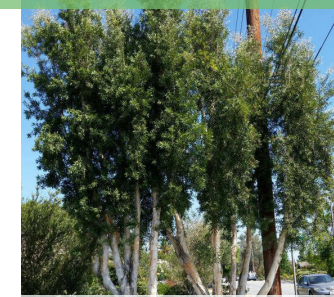

*Melaleuca quinquenervia*  
(Broad-leaved Paperbark)

## PARK TREES



*Syzygium hemilampra*  
(Broad-leaved Lilly Pilly)

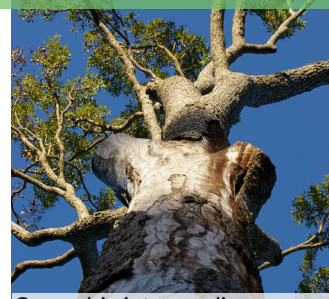

*Corymbia intermedia*  
(Pink Bloodwood)

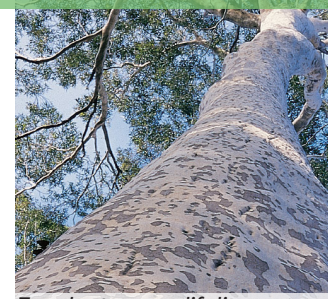

*Eucalyptus amplifolia*  
(Cabbage Gum)



*Eucalyptus racemosa*  
(Scribbly Gum)

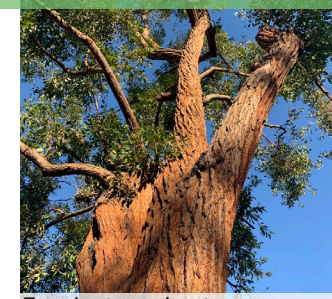

*Eucalyptus robusta*  
(Swamp Mahogany)



*Eucalyptus tereticornis*  
(Forest Red Gum)







Learn more about the Lowood Futures Strategy: [somersex.gov.au/major-projects](https://somersex.gov.au/major-projects)  
For more information, contact Council on 5424 4000 or [mail@somersex.gov.au](mailto:mail@somersex.gov.au)